

TT one

SS2151XLEM/XLET

TT one is a typical parcan which has single-facet-light effect. It is adopting the trailblazing creative RGBL source, possessing the stunning washing effect and the abundant color mixing effect. Besides, TV-one is implanted with CCS technology, and the CRI is greater than 85Ra. T-one is perfect for the theatrical and TV, Stucio applications.



SS2151XLEM



SS2151XLET



PRODUCT PARAMETERS

Optical system

Light source
200W RGBL

Luminous flux
9600lm

Angle
15°-45°

Illuminance
2000lx @5m, 15°

Appearance

Size 404x304x209mm Casing Magnalium and Die-cast
Weight 5.5kg Color Black

Electrical Specs

Voltage
100-240VAC,50/60Hz

Max. Power
200W

Power Connection
Seetronic power input and output

Signal socket
3pin or 5pin in and out

Control System

Dimmer
0-100% 24 Bit

Cooling
Forced Convection

Control
DMX512, RDM, NFC

Personality
BASIC、SSP、TOUR、TR16、HSIC、CMY

Display
On board Control , Custom Mode , 0-25Hz Strobe

Work Environment Certification

Ambient Temp
-20°C-45°C

IP Rated
IP66

ILLUMINANCE AT DISTANCE SS2151XLEM

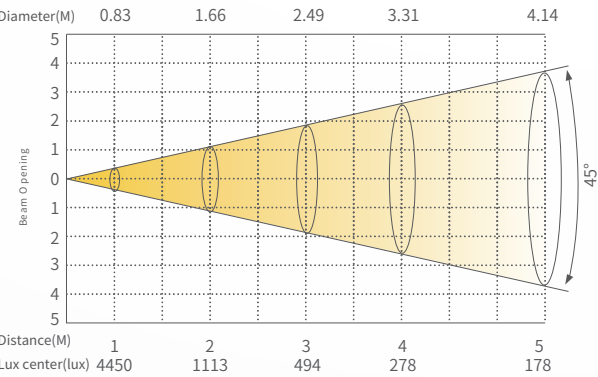
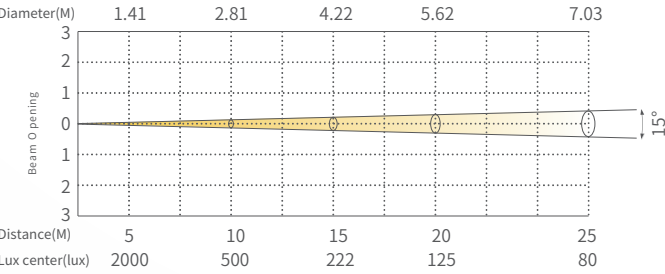

DIMENSIONS

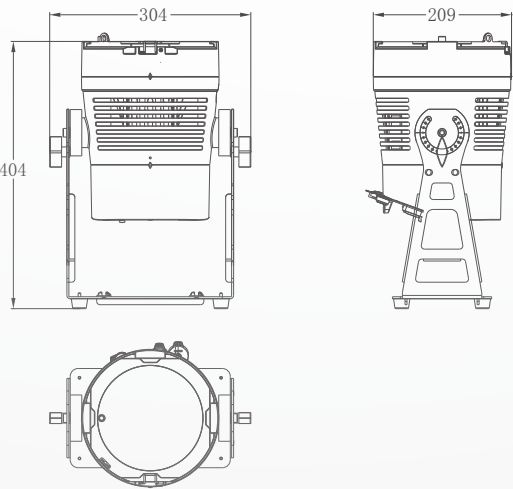

ACCESSORIES (Accessories not included unless otherwise stated)

