

NEPTUN BX5-HT
SS9475SCM

PROFESSIONAL STAGE LIGHTING OEM&ODM MANUFACTURER

1 PRODUCT

1.1 TECHNICAL SPECIFICATIONS

Type	SS9475SCM
LED colors	500W Laser source
Angle	0.4-45°
Power	750W
Control Protocol	DMX512, RDM, sACN, ARTNET, NFC, CRMX(Optional)
Voltage Range	100-240V~,50/60Hz
Input Current	110V/7A,220V/3.5A
Protection	IP66
Operation Temperature	-20℃~45℃
Dimensions	501x368x831mm
Weight	59.3kg

Dimensional Drawing

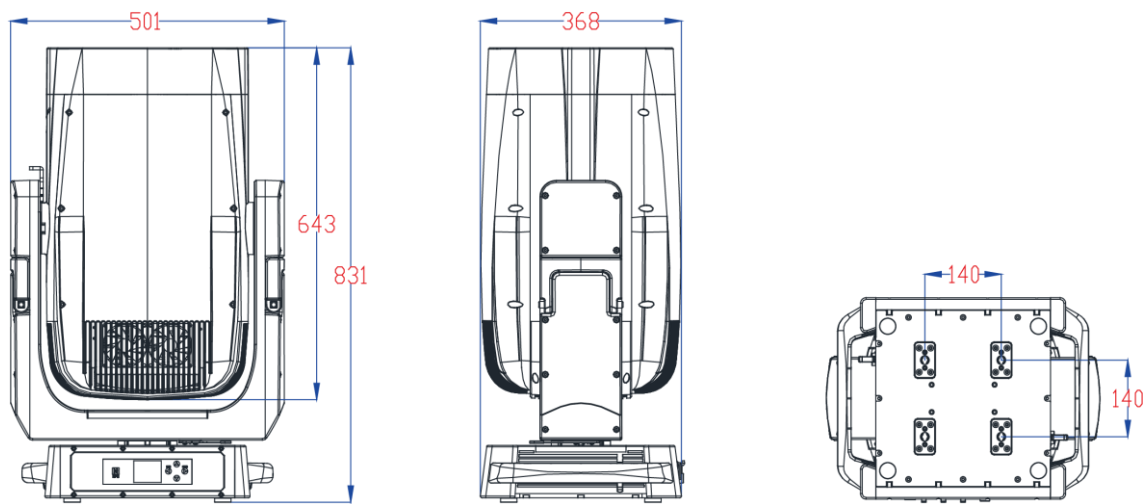

1.2 Safety Notes

IMPORTANT

- This product must be installed by a qualified professional.
- In order to maintain this condition and to ensure a safe operation, it is absolutely necessary for the user to follow the safety instructions and warning notes
- The manufacturer will not accept liability for any resulting damages caused by the non-observance of this manual or any unauthorized modification to the device.

CAUTION!

- Make sure that the available voltage is not higher than stated on the rear panel.
- Do not touch the power cables if your hands are wet.
- The earth wire must always be connected to the ground. Therefore it is essential to connect the yellow/green conductor to earth.
- Make sure that the power-cord is never crimped or damaged by sharp edges. Check the device and the power-cord from time to time. The electric connection, repairs and servicing must be carried out by a qualified employee.
- Always disconnect power input cable to completely remove power from unit when not in use or before cleaning or servicing the fixture.
- Do not switch the fixture on and off in short intervals as this would reduce the lamp's life.
- Do not touch the device's housing bare hands during its operation (housing becomes hot)! The surface of the product's casing can reach up to 70° C (158° F) during operation. Avoid contact by persons and materials. Do not install the product in a location where there is a risk of accidental contact. Allow the product to cool for at least 10 minutes before handling.
- For replacement use lamps and fuses of same type and rating only.
- Please protect the fixture and avoid destroy during transport and installation. If there is any damage to the coating, the shell may be corroded.
- When hanging lamps and lanterns, it is necessary to verify that facilities and hooks can bear at least 10 times the weight of lamps and lanterns.
- Fix the safety rope at the correct holes only. Only operate the fixture after having checked that the housing is firmly closed and all screws are tightly fastened.
- The ambient temperature of this device is -20°C -45°C, please use the lighting fixtures within this range. (Note: When the laser light source detects a temperature between -20°C and 0°C, the device needs to heat the internal temperature to above 0°C before it lights up.)
- During the initial start-up some smoke or smell may arise. This is a normal process and does not necessarily mean that the device is defective.

Electrical Warning

- The light source contained in this luminaire shall only be replaced by the manufacturer or his service agent or a similar qualified person
- For replacement use lamps and fuses of same type and rating only.
- The lens has to be replaced when it is obviously damaged, so that its function is impaired, e. g. due to cracks or deep scratches!

Keep the product well away from flammable materials

- Keep all combustible materials (e.g. fabric, wood, paper) at least 1200 mm (47 in.) away from the product.

- Ensure that there is free and unobstructed airflow around the product. Provide a minimum clearance of 150 mm (6 in.) around fans and air vents.
- Do not illuminate surfaces within 45m (148ft.) of the product.
- Do not install a fuse that has a higher rating than the one originally installed in the product. Do not bypass fuses.
- Do not stick filters, masks or other materials onto optical components.
- If the fixture seems to be abnormally hot, shows signs of melting or emits smoke, disconnect the fixture from power immediately and allow it to cool. Do not touch the fixture without heatproof safety gloves. Keep the fixture well away from combustible and flammable materials.

**NEVER LOOK DIRECTLY INTO THE LIGHT SOURCE!
RETINA INJURY RISK - MAY INDUCE BLINDNESS!**

Do not point the front of the fixture towards the sun or other strong light sources. The front lens focuses and concentrates light just like a magnifying glass. Strong light can cause internal damage to the fixture, melting components or starting an internal fire within seconds.

To avoid problems from strong light sources:

- Do not expose the front of a fixture to sunlight or any other strong light source. Avoid pointing other high-powered beam lights directly at the fixture.
- Do not focus a light beam from one lighting fixture directly towards another.
- For outdoor applications during daylight, make sure that the front face of any fixture is shielded or points away from the sun, even when not in use.
- Do not expose the product to heat (from other lighting fixtures for example).

2 INSTALLATION

2.1 MOUNTING

Truss installation

- ◆ Keep all combustible materials (e.g. fabric, wood, paper) at least 500 mm (20 in.) away from the product.
- ◆ For overhead use, always install a safety cable that can hold at least 10 times the weight of the fixture.
- ◆ For overhead installation, the fixture must be always secured with a safety wire that can bear at least 10 times the weight of the fixture;
- ◆ Secure the fixture with a safety cable through the rear safety eye and truss as shown..
- ◆ Ensure that the structure (truss) to which you are attaching the fixture is secure

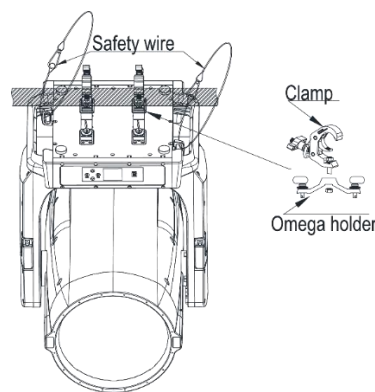

FIXTURE MOUNTING POSITION

- ◆ The fixture may be mounted in any position in which the base of the fixture is oriented horizontally.
- ◆ Acceptable positions include standing the fixture upright or hanging the fixture upside-down.
- ◆ Do NOT install the fixture in a sideways position, or in any position in which the base of the fixture is oriented vertically or at an angle.

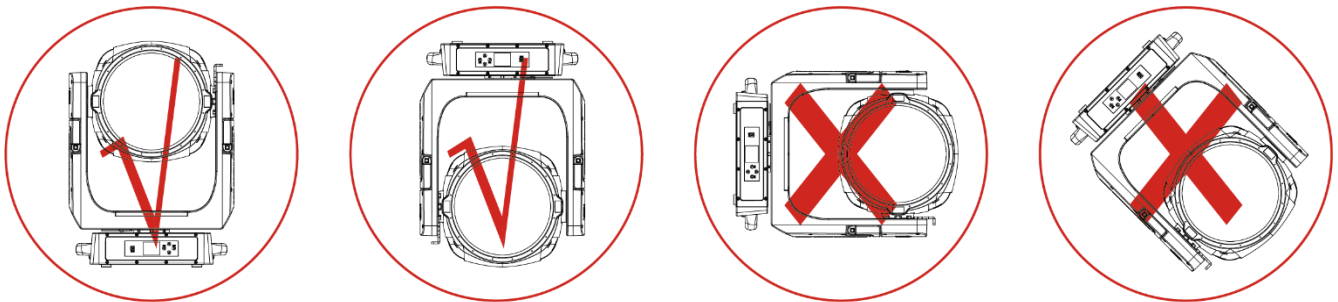

2.2 Fuse replacement

- ◆ Remove the safety cap by a screwdriver.
- ◆ Fetch the old fuse from safety cap.
- ◆ Install a new fuse.
- ◆ Install the safety cap.

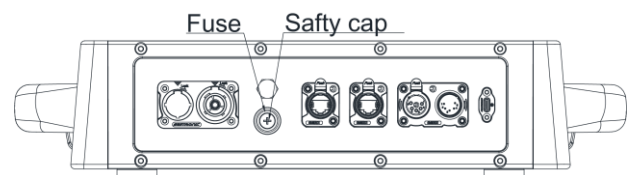

2.3 POWER CONNECTIONS

- ◆ POWER Linking: 1 units@110V; 2 units@220V.
- ◆ This product has an auto-ranging power supply that can work with an input voltage range of 100–240 VAC, 50/60 Hz.

AC Plug

Connection	Wire (U.S.)	Wire(Europe)	Screw Color
AC Live	Black	Brown	Yellow/Brass
AC Neutral	White	Blue	Silver
AC Ground	Green/Yellow	Green/Yellow	Green

2.4 Data network requirements

- ◆ Connect the DMX512 controller to the units in series. A DMX 512 data link is required in order to control the fixture via DMX. The fixture has 3/5-pin XLR connectors for DMX data input and output.
- ◆ Each unit has N DMX channels so the DMX Addresses should increase by increments of 1, (Nx1)+1, (Nx2)+1, (Nx3)+1...
- ◆ Any DMX address in the range from 001 to 512 may be used.
- ◆ Connect the DMX-output of the first fixture in the DMX chain with the DMX-input of the next fixture. Always connect one output with the input of the next fixture until all fixtures are connected.
- ◆ Caution: At the last fixture, the DMX-cable has to be terminated with a terminator. Solder a 120 Ω resistor between Signal (-) and Signal (+) into a 3/5-pin XLR-plug and plug it in the DMX-output of the last fixture.

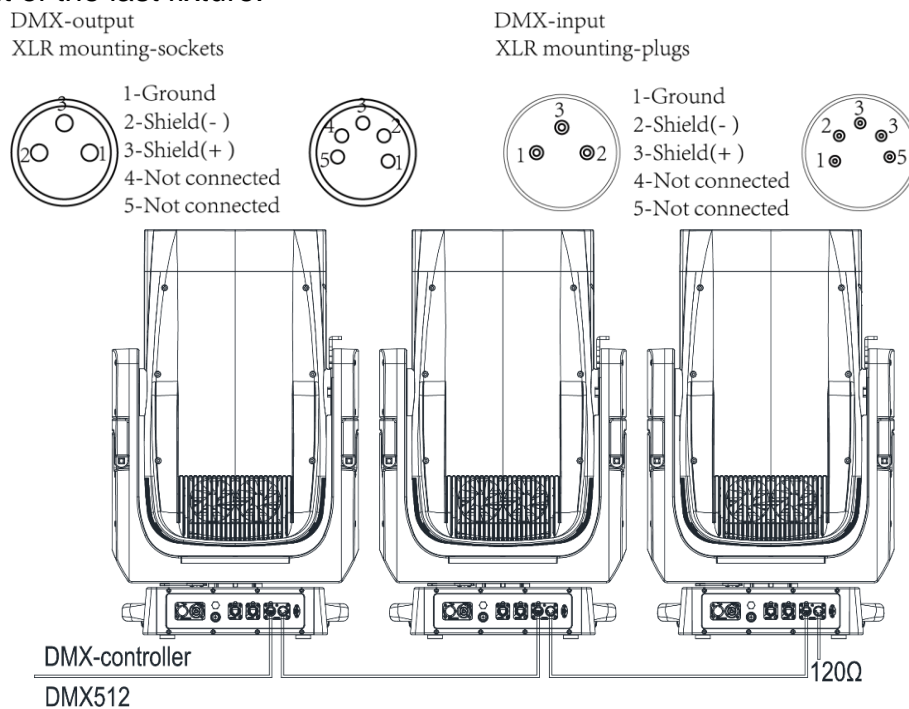

2.5 Update software

- ◆ Steps of updating software with USB-C interface:
 1. Insert USB-C U dish into USB-C interface
 2. After finding "Upgrade Software" in the menu, Find the corresponding software and click OK

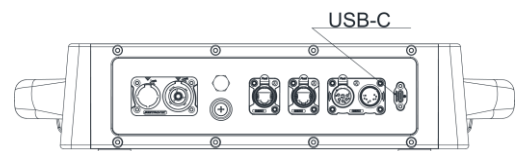

3 FUNCTIONS AND SETTINGS

3.1 DISPLAY OPERATION

- ◆ MENU: Used to access the menu or to return a previous menu option;
- ◆ ENTER: Used to select and store the current menu or confirm the current function value or option within a menu;
- ◆ UP: Navigates downwards through the menu list and increases the numeric value when in a function;
- ◆ DOWN: Navigates upwards through the menu list and decreases the numeric value when in a function;
- ◆ Lock screen password: Long press 5s Left, Input after the screen is bright - UP/DOWN/UP/DOWN

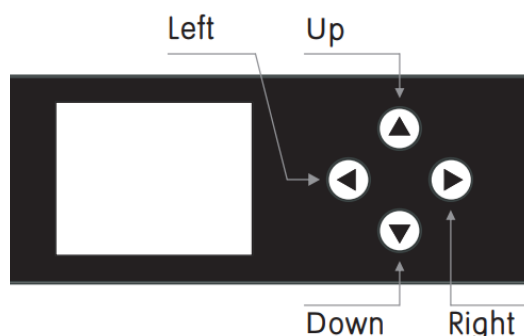

3.2 Menu Map

ADDRESS	001 – 512(Default 001)			DMX address setting		
PERSON	BASIC			Use the menu to select desired channel mode		
	STANDARD (Default)					
	EXTEND					
RUNMODE	DMX512 (Default)			Select Signal		
	ARTNET			Default: DMX512		
	ARTNET TO DMX			CUSTOM1-2 Set up get into EDIT		
	sACN			MENU edit		
	AUTO					
	CUSTOM1					
	CUSTOM2					
OPTION	PAN/TILT SETTING	PAN INVERT	NORMAL(Default)		PAN moving direction selection	
			INVERT			
		TILT INVERT	NORMAL(Default)		TILT moving direction selection	
			INVERT			
		PT ENCODER	OFF		PAN moving degree selection	
			ON(Default)			
		SAFETY LIMIT	PAN(-)	-270 ~ -1	Rotation angle limit	
			PAN(+)	1 ~ 270		
			TILT (-)	-135 ~ -1		
			TILT (+)	1 ~ 135		

		BLACKOUT	OFF (Default)		Select OFF blackout without delay
			ON		Select ON Blackout delay 3s
DIMMER SETTING	DIMMER SPEED		HALOGEN		Dimming speed LED (fast) to
			OFF(Default)		Halogen (slow);
	DIMMER CURVE		LINEAR		Sets the Dimmer curve
			SQUARE LAW (Default)		
			INV. SQUARE LAW		
			S-CURVE		
	LED PWM		1200Hz (Default)		Sets the PWM frequency
			2400Hz		
			4000Hz		
			6000Hz		
			25000Hz		
DISPLAY SETTING	DISPLAY LOCK		OFF		Locks display (passcode is <UP>, <DOWN>,<UP>, <DOWN>, <ENTER>)
			ON (Default)		
	DISPLAY TIME		On		Display backlight always on
			30s (Default)		Turns off display backlight after 30s/1min
			1min		
			2min		/2min of inactivity
	LANGUAGE	****	Chinese		Language selection
			ENGLISH		
SUN PROTECTION	OFF(Default)		Turn the fixtures Head to earth		
	ON				
PERFORM	STUDIO		Fan mode low speed		
	POWER		Fast rotation of fan, all power		
	LIVE (Default)		Automatic rotation of fan		
DMX ERROR	SAVE (Default)		Hold after loss of DMX signal		
	BLACK		Blackout after loss of DMX signal		
LOAD PARA	NO		Not upload data		
	YES		Upload data		
SETTING	RECOVERY	****	Restore default factory settings.		
	RESET LIMITS	****	Reset XY limit		
	CLEAN EDIT1	****	Clean customer self-editing scene 1		
	CLEAN EDIT2	****	Clean customer self-editing scene 2		
	WDMX HIDE	NO(Default)		Hide wireless mode WDMX reset and signal hide and the default is wired mode only	
		YES			

EDIT	NETWORK	NET SWITCH	2.xxx.xxx.xxx(Default)		Net switch off IP mode
			10.xxx.xxx.xxx		Net switch on IP mode
		UNIVERS	0-255		Packet group Settings
		IP MODE	DEFAUL IP(Default)		Default IP
			CUSTOM IP		Customer's IP
		CUSTOM IP	XX.XX.XX.XX		Customer's IP setting
	SIGNAL	ONLY XLRDMX (Default)			ONLY XLR is wire only
		XLRDMX FIRST			XLR FIRST is wire first
		ONLY WDMX			ONLY WDMX is wireless only
		WDMX FIRST			WDMX FIRS is wireless first
		WDMX TO XLRDMX			WDMX TO DMX is wireless to wired
	WDMX RESET	NO(Default)			Do not clear the receiver's message
		YES			Clear the receiver's message
	EDIT 1-2	STEP 1-30	PAN	0-255	Edit the custom programs1-30 Select play 【EDIT 1】 in RUNMOEDE CUSTOM 1; Select play 【EDIT 2】 in RUNMOEDE CUSTOM 2
			TILT	0-255	
			PT SPEED	0-255	
			PAN ROTA	0-255	
CMY_C			0-255		
CMY_M			0-255		
CMY_Y			0-255		
CTO			0-255		
COLOR			0-255		
ROTA.GOBO			0-255		
GOBO.ROTA			0-255		
FIXED GOBO			0-255		
P/F 1 INDEX			0-255		
PRISM 1 ROTA			0-255		
P/F 2 INDEX			0-255		
PRISM 2 ROTA			0-255		
ZOOM			0-255		
FOCUS			0-255		
DIMMER			0-255		
STROBE		0-255			
TIME	0-255				
USE	YES/NO	Select YES to run the steps user need.			
MANUAL	Auto Test				Auto Test channel
	CHANNEL	PAN	0-255		Manual control channel
		TILT	0-255		
		PT SPEED	0-255		
		PAN ROTA	0-255		

		CMY_C	0-255	
		CMY_M	0-255	
		CMY_Y	0-255	
		CTO	0-255	
		COLOR	0-255	
		ROTA.GOBO	0-255	
		GOBO.ROTA	0-255	
		FIXED GOBO	0-255	
		P/F 1 INDEX	0-255	
		PRISM 1 ROTA	0-255	
		P/F 2 INDEX	0-255	
		PRISM 2 ROTA	0-255	
		ZOOM	0-255	
		FOCUS	0-255	
		DIMMER	0-255	
		STROBE	0-255	
	DEBUG HIDE	YES		Factory testing mode. All stepper motors are not controlled by signal, It only works again after the reset.
		NO		
	RESET	ALL RESET		Select Yes/No to carry out all reset
		XY RESET		Select Yes/No to carry out P/T reset
		COLOR GOBO SYS		Color/CMYK reset
		ZOOM FOCUS RESET		Focus/Zoom reset
INFO	VERSION		Software versions	
	TEMPERATURE		LED temperature	
	FAN SPEED		Fan speed detection	
	FIXTURE HOURS		Hours of fixture use	
	LASER USE HOURS		LED use time	
	NETWORK		network address	
	RDM	UID	0x388Axxxxxxxx	Check fixture's ID
		LABEL		Check fixture's LABEL
	SYSTEM ERROR	MEMORY IC		Memory IC
		ANGLESENSOR		Angle Sensor
		PAN SENSOR		Pan Sensor
		PAN ENCODER		Pan Encoder
		PAN DRIVE OWT		PAN DRIVE OWT
		PAN DRIVE FAULT		PAN DRIVE FAULT
		TILT SENSOR		Tilt Sensor
		TILT ENCODER		Tilt Encoder

		PAN DRIVE OWT		PAN DRIVE OWT		
		PAN DRIVE FAULT		PAN DRIVE FAULT		
		LASER RESET		LASER RESET		
		CMY_C RESET		CMY C Reset		
		CMY_M RESET		CMY M Reset		
		CMY_Y RESET		CMY Y Reset		
		COLOR RESET		Color Reset		
		GOBO RESET		Gobo Reset		
		RGOBO RESET		Rotate Gobo Reset		
		FIXED GOBO		Fixed Reset		
		P/F 1 INDEX RESET		P/F 1 Index Reset		
		PRISM 1 ROTA RESET		Prism 1 Rota Reset		
		P/F 2 INDEX RESET		P/F 2 Index Reset		
		PRISM 2 ROTA RESET		Prism 2 Rota Reset		
		ZOOM RESET		Zoom Reset		
		FOCUS RESET		Focus Reset		
		NETWORK IC		Network IC		
		RVICE	****	PAN	±127	Pan position fine adjustment
				TILT	±127	Tilt position fine adjustment
CMY-C	±127			CMY-C position fine adjustment		
CMY-M	±127			CMY-M position fine adjustment		
CMY-Y	±127			CMY-Y position fine adjustment		
COLOR	±127			CTO position fine adjustment		
ROTA. GOBO	±127			Rotate Gobo position fine adjustment		
GOBO.ROTA	±127			Self-rotation position fine adjustment		
FIXED GOBO	±127			Fixed Gobo position fine adjustment		
P/F 1 INDEX	±127			P/F 1 position fine adjustment		
PRISM 1 ROTA	±127			Prism 1 position fine adjustment		
P/F 2 INDEX	±127			P/F 2 position fine adjustment		
PRISM 2 ROTA	±127			Prism 2 position fine adjustment		
ZOOM	±127			Zoom position fine adjustment		
FOCUS	±127			Focus position fine adjustment		
UPDATE SOFTWARE				Update software		
All passwords of this product are <UP>, <DOWN>,<UP>, <DOWN>, <ENTER>						

4 USING A DMX512 CONTROLLER

4.1 DMX CONTROL

BASIC (23CH)	STANDARD (28CH)	Extend (34CH)	VALUE	Functions
1	1	1	000-255	PAN
-	2	2	000-255	PAN FINE
2	3	3	000-255	TILT
-	4	4	000-255	TILT FINE
3	5	5	000-255	PT Speed
4	6	6	PAN Motor continuous rotation	
			0-63	stop rotation by spinout
			64-127	stop rotation by shortcut
			128-189	Forwards Pan rotation from fast to slow
			190-193	No rotation
			194-255	Backwards Pan rotation from slow to fast
5	7	7	000-255	CYAN
-	-	8	000-255	CYAN FINE
6	8	9	000-255	MAGENTA
		10	000-255	MAGENTA FINE
7	9	11	000-255	YELLOW
-	-	12	000-255	YELLOW FINE
8	10	13	000-255	CTO
-	-	14	000-255	CTO FINE
9	11	15	COLOUR MACRO	
			0-10	No Function
			11-20	L106
			21-30	L194
			31-40	L019
			41-50	R08
			51-60	L213
			61-70	R80
			71-80	L202
			81-90	L328
			91-100	R3314
			101-110	L101
			111-120	L768
			121-128	No Function
			129-147	CYAN 100% / MAGENTA UP / YELLOW 0%
			148-166	CYAN DOWN / MAGENTA 100% / YELLOW 0%
			167-185	CYAN 0% / MAGENTA 100% / YELLOW UP
			186-204	CYAN 0% / MAGENTA DOWN / YELLOW 100%
			205-223	CYAN UP / MAGENTA 0% / YELLOW 100%

			224-242	CYAN 100% /MAGENTA 0%/YELLOW DOWN
			243-255	CYAN 100%/MAGENTA UP/YELLOW 0%
10	12	16	000-255	CMY SPEED(SPEED 100%->1)
11	13	17	COLOR WHEEL 19+1	
			0-5	WHITE
			6	COLOR 1
			7	COLOR 2
			8	COLOR 3
			9	COLOR 4
			10	COLOR 5
			11	COLOR 6
			12	COLOR 7
			13	COLOR 8
			14	COLOR 9
			15	COLOR 10
			16	COLOR 11
			17	COLOR 12
			18	COLOR 13
			19	COLOR 14
			20	COLOR 15
			21	COLOR 16
			22	COLOR 17
			23	COLOR 18
			24	COLOR 19
			25	COLOR 20
			26	COLOR 21
			27	CTO1
			28	CTO2
			29	CTO3
			30	CTO4
			31	CTO5
			32	CTO6
			33	CTO7
			34	CTO8
			35	CTO9
			36	CTO10
			37	CTO11
			38	CTO12
			39	CTO13
			40-191	COLOR WHELL1 0-360°
			192-222	COLOR WHELL1 RAINBOW EFFECT(SPEED 100%->1)
			223-224	STOP
			225-255	COLOR WHELL1 RAINBOW EFFECT (SPEED 1->100%)
-	-	18	000-255	COLOR WHEEL FINE

12	14	19	ROTATING GOBO 12+1	
			0-5	ROTATING WHITE
			6-10	ROTATING GOBO 1
			11-15	ROTATING GOBO 2
			16-20	ROTATING GOBO 3
			21-25	ROTATING GOBO 4
			26-30	ROTATING GOBO 5
			31-35	ROTATING GOBO 6
			36-40	ROTATING GOBO 7
			41-45	ROTATING GOBO 8
			46-50	ROTATING GOBO 9
			51-55	ROTATING GOBO 10
			56-60	ROTATING GOBO 11
			61-65	ROTATING GOBO 12
			66-70	ROTATING GOBO 1 SHAKE (SPEED 1 → 100%)
			71-75	ROTATING GOBO 2 SHAKE (SPEED 1 → 100%)
			76-80	ROTATING GOBO 3 SHAKE (SPEED 1 → 100%)
			81-85	ROTATING GOBO 4 SHAKE (SPEED 1 → 100%)
			86-90	ROTATING GOBO 5 SHAKE (SPEED 1 → 100%)
			91-95	ROTATING GOBO 6 SHAKE (SPEED 1 → 100%)
			96-100	ROTATING GOBO 7 SHAKE (SPEED 1 → 100%)
			101-105	ROTATING GOBO 8 SHAKE (SPEED 1 → 100%)
			106-110	ROTATING GOBO 9 SHAKE (SPEED 1 → 100%)
			111-115	ROTATING GOBO 10 SHAKE (SPEED 1 → 100%)
			116-120	ROTATING GOBO 11 SHAKE (SPEED 1 → 100%)
			121-125	ROTATING GOBO 12 SHAKE (SPEED 1 → 100%)
			126-127	WHITE
			128-190	ROTATING GOBO FLOWING WATER EFFECT (SPEED 100 → 1%)
			191-192	STOP WATER EFFECT
			193-255	ROTATING GOBO FLOWING WATER EFFECT (SPEED 1 → 100%)
13	15	20	GOBO ROTATING	
			0-120	ROTATING GOBO ANGLE ADJUSTMENT (0 → 360°)
			121-125	STOP
			126-165	ROTATING GOBO SHAKE (SPEED 1 → 100%)
			166-170	STOP
			171-210	ROTATING GOBO POSITIVE ROTATION (SPEED 100% → 1)
			211-215	STOP
			216-255	ROTATING GOBO REVERSE ROTATION (SPEED 1 → 100%)
-	-	21	000-255	GOBO ROTATING FINE
14	16	22	FIXED GOBO WHEEL 25+1	
			0-5	WHITE
			6	FIXED GOBO 1
			7	FIXED GOBO 2
			8	FIXED GOBO 3

			9	FIXED GOBO 4
			10	FIXED GOBO 5
			11	FIXED GOBO 6
			12	FIXED GOBO 7
			13	FIXED GOBO 8
			14	FIXED GOBO 9
			15	FIXED GOBO 10
			16	FIXED GOBO 11
			17	FIXED GOBO 12
			18	FIXED GOBO 13
			19	FIXED GOBO 14
			20	FIXED GOBO 15
			21	FIXED GOBO 16
			22	FIXED GOBO 17
			23	FIXED GOBO 18
			24	FIXED GOBO 19
			25	FIXED GOBO 20
			26	FIXED GOBO 21
			27	FIXED GOBO 22
			28	FIXED GOBO 23
			29	FIXED GOBO 24
			30	FIXED GOBO 25
			31-33	FIXED GOBO 1 SHAKE (SPEED 1 → 100%)
			34-36	FIXED GOBO 2 SHAKE (SPEED 1 → 100%)
			37-39	FIXED GOBO 3 SHAKE (SPEED 1 → 100%)
			40-42	FIXED GOBO 4 SHAKE (SPEED 1 → 100%)
			43-45	FIXED GOBO 5 SHAKE (SPEED 1 → 100%)
			46-48	FIXED GOBO 6 SHAKE (SPEED 1 → 100%)
			49-51	FIXED GOBO 7 SHAKE (SPEED 1 → 100%)
			52-54	FIXED GOBO 8 SHAKE (SPEED 1 → 100%)
			55-57	FIXED GOBO 9 SHAKE (SPEED 1 → 100%)
			58-60	FIXED GOBO 10 SHAKE (SPEED 1 → 100%)
			61-63	FIXED GOBO 11 SHAKE (SPEED 1 → 100%)
			64-66	FIXED GOBO 12 SHAKE (SPEED 1 → 100%)
			67-69	FIXED GOBO 13 SHAKE (SPEED 1 → 100%)
			70-72	FIXED GOBO 14 SHAKE (SPEED 1 → 100%)
			73-75	FIXED GOBO 15 SHAKE (SPEED 1 → 100%)
			76-78	FIXED GOBO 16 SHAKE (SPEED 1 → 100%)
			79-81	FIXED GOBO 17 SHAKE (SPEED 1 → 100%)
			82-84	FIXED GOBO 18 SHAKE (SPEED 1 → 100%)
			85-87	FIXED GOBO 19 SHAKE (SPEED 1 → 100%)
			88-90	FIXED GOBO 20 SHAKE (SPEED 1 → 100%)
			91-93	FIXED GOBO 21 SHAKE (SPEED 1 → 100%)
			94-96	FIXED GOBO 22 SHAKE (SPEED 1 → 100%)

			97-99	FIXED GOBO 23 SHAKE (SPEED 1 → 100%)
			100-102	FIXED GOBO 24 SHAKE (SPEED 1 → 100%)
			103-105	FIXED GOBO 25 SHAKE (SPEED 1 → 100%)
			106-127	WHITE
			128-190	STATIC GOBO JUMPING WATER EFFECT (SPEED 100 → 1%)
			191-192	STOP WATER EFFECT
			193-255	STATIC GOBO FLOWING WATER EFFECT (SPEED 1 → 100%)
15	17	23	P/F INDEX 1	
			0-10	WHITE
			11-50	PRISM 1
			51-100	PRISM 2
			101-150	PRISM 3
			151-200	FROST 1
			201-255	FROST 2
16	18	24	PRISM 1	
			0-10	WHITE
			11-145	PRISM INSERT AND ADJUST THE ANGLE (0 → 360°)
			146-150	STOP
			151-200	PRISM INSERT AND POSITIVE ROTATION (SPEED 100% → 1)
			201-205	STOP ROTATION
			206-255	PRISM INSERT AND REVERSE ROTATION (SPEED 1 → 100%)
17	19	25	P/F INDEX 2	
			0-10	WHITE
			11-50	PRISM 4
			51-100	PRISM 5
			101-150	PRISM 6
			151-200	PRISM 7
			201-255	FROST 3
18	20	26	PRISM 2	
			0-10	WHITE
			11-145	PRISM INSERT AND ADJUST THE ANGLE (0 → 360°)
			146-150	STOP
			151-200	PRISM INSERT AND POSITIVE ROTATION (SPEED 100% → 1)
			201-205	STOP ROTATION
			206-255	PRISM INSERT AND REVERSE ROTATION (SPEED 1 → 100%)
19	21	27	000-255	ZOOM
			12	Minimum angle
			128	Medium angle
			255	Maximum angle
	22	28	000-255	ZOOM FINE
20	23	29	000-255	FOCUS
			0	Minimum angle
			148	Medium angle

			255	Maximum angle
-	24	30	000-255	FOCUS FINE
21	25	31	000-255	DIMMER
	26	32	000-255	DIMMER FINE
22	27	33	STROBE	
			0-9	NO FUNCTION
			10-99	STROBE (FROM SLOW TO FAST)
			100-109	NO FUNCTION
			110-179	LIGHTNING STROBE
			180-189	NO FUNCTION
			190-255	RANDOM SROBE
23	28	34	CONTROL CHANNEL	
			0-10	NO FUNCTION
			11-15	PAN/TILT BLACK ACTIVATED
			16-20	PAN/TILT BLACK DEACTIVATED
			21-25	PAN INVERT
			26-30	TILT INVERT
			31-35	PAN/TILT INVERT OFF
			36-100	RESERVED
			101-105	STUDIO
			106-110	POWER
			111-115	LIVE
			116-120	RESERVED
			121-125	DIMMER SPEED Halogen
			126-130	DIMMER SPEED LED
			131-135	DIMMER CURVE LINEAR
			136-140	DIMMER CURVE SQUARE LAW
			141-145	DIMMER CURVE INV. SQUARE LAW
			146-150	DIMMER CURVE S-CURVE
			151-160	RESERVED
			161-165	1200Hz
			166-170	2400Hz
			171-175	4000Hz
			176-180	6000Hz
			181-185	25000Hz
			186-200	RESERVED
			201-205	ALL RESET
			206-210	XY RESET
			211-215	COLOR GOBO PRISM SYS
			216-220	FOCUS\ZOOM RESET
			221-255	RESERVED



广州市雅江光电设备有限公司

Guangzhou Yajiang Photoelectric Equipment Co., Ltd.

电话/Tel : 020-86947788 邮箱/E-mail : sales@yajiang.cn
传真/Fax : 020-86943773 网址/Website : www.yajiang.cn